

# KINESIO® TAPE FOR **CANINE**



JOINT RELIEF



WATER RESISTANT



HOLISTIC



HYPO-ALLERGENIC



## Kinesio Canine™ Tape: Designed Specifically for Dogs...

The Kinesio Taping® Method can be used for equine and canine rehabilitation, postural changes, musculoskeletal issues, and with complementary therapies.

Kinesio Tape® and the Kinesio Taping® Method have been used successfully to treat a variety of orthopedic, neuromuscular, neurological and medical conditions not only for people but for **horses, dogs and other small animals worldwide.**

Kinesio® Canine Tape is designed specifically for dogs. Kinesio® Canine Tape is made of 100% high grade cotton for breathability and comfort. The tape's adhesive is 100% medical grade and is heat activated.

There is no medicine in the tape. All dyes are hypoallergenic, and naturally derived from plant extracts. Kinesio Canine Tape is lightweight, breathable, and allows full range of motion. It can be left on 24 hours a day for up to 5 days.



The hair follicles of dogs often have several hairs growing out to one follicle.

Kinesio® tape for canine works with a dog's hair follicles to stimulate the deeper tissue layers, creating more space to help lymphatic fluids to flow more freely which aids in healing and helps reduce swelling.



## Introducing Our NEW Book: **Kinesio Taping® Canine for Dog Lovers**

Our new book, discusses what to look for and describes symptoms to help a dog owner quickly discover the best Certified Kinesio Taping™ application to use. Included are clearly written, step by step directions and detailed illustrations to help dog owners easily apply Kinesio Taping® canine applications to the target areas.

Always consider the history or circumstances surrounding the appearance of pain or injury. Always talk with your veterinarian and discuss your dog's health and needs.

## Kinesio Canine™ Applications: Examples of the numerous applications developed by Kinesio®

### Foreleg Elbow Damage

*Even dogs "tweak" their elbows through their active lifestyles*

Impacting Paw Flexion.

#### DIRECTIONS:

1. Put the base of the tape outside the elbow joint.
2. Put the tape at 20% tension towards with the front leg feet dorsal area.
3. Place the second piece of tape in the center so as to cover the affected area with 70% tension.

*Make sure that both sides except the center are rubbed in place firmly with no tension.*

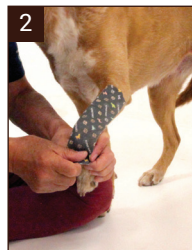
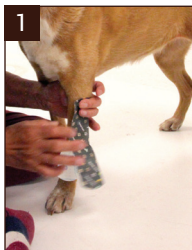

Completed Application

### Patellar Dislocation

*This is like a slipped kneecap on your dog.*

Patellar Dislocation.

#### DIRECTIONS:

1. Put the base of the Y-shaped tape on the front of the upper thigh. Pull back hind legs and put on tape up to the top of the knee joint with 20% tension.
2. With the knees bent, apply one end of the outside of the Y-shaped tape with 20% tension so as to wrap the patella. With the knees bent, apply other end of the inside of the Y-shaped tape with a 20% tension so as to wrap the patella.
3. Put the base of the second Y-shaped tape on the back of the knee. One end of the upper side of the second Y-shaped tape passes through the upper part of the knee joint and is put inward with a 20% tension. The other end on the lower side passes through the lower side of the knee joint and is placed inwardly with 20% tension.

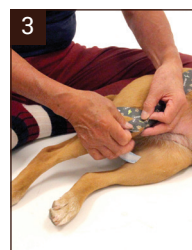
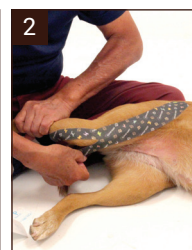

Completed Application

More information about Kinesio products and application videos are available online at  
**kinesiotaping.com • kinesiotaping.com/canine • 888-320-TAPE (8273) • canine@kinesiotaping.com**